

© Crown copyright and database rights 2024 OS LA100019567. You are granted a non-exclusive, royalty free, revocable licence solely to view the Licensed Data for non-commercial purposes for the period during which Leeds City Council makes it available. You are not permitted to copy, sub-licence, distribute, sell or otherwise make available the Licensed Data to third parties in any form. Third party rights to enforce the terms of this licence shall be reserved to OS.

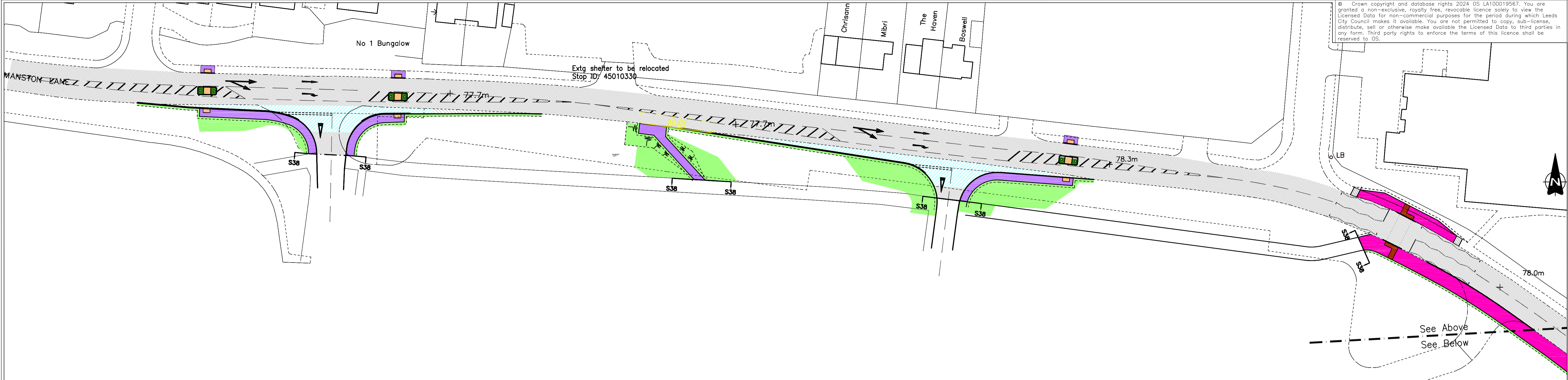

KEY	
	SITE BOUNDARY/LIMIT OF CONSTRUCTION WORKS
	NEW CARRIAGEWAY
	CARRIAGEWAY OVERLAY
	FOOTWAY WORKS
	CONTROLLED CROSSING (RED TACTILES)
	UNCONTROLLED CROSSING (BUFF TACTILES)
	LANDSCAPE / GRASSED AREA
	SHARED FOOTWAY

**Notes:**  
 1. This drawing is for information only. See relevant Contract Drawings for actual construction details and proposed works.

P01.01 FOR SAFETY AUDIT	RP				
REV	DRAWN	CHECK	DATE	CDE	
CREATED BY:	RP	10/23	CURRENT ISSUE:	CHECKED	CDE APPROVAL
PURPOSE OF ISSUE:	WORKS IN PROGRESS				
APPROVAL STATUS:	<b>DRAFT</b>			CDE STATUS:	A5
MANSTON LANE S278 HIGHWAY WORKS GENERAL ARRANGEMENT					
1:500				ORIGINAL SHEET SIZE:	A1
733366-LCC-HWT-XX-DR-01_001					REV: P01.01
February 2024					ID: 733366